

SAFE . FUNCTIONAL . DESIGN

PADEL

The Fastest Growing Sport in the World!

WWW.IRMARFER.CH
office@irmarfer.ch

IRMARFER
STRUCTURES **CH**

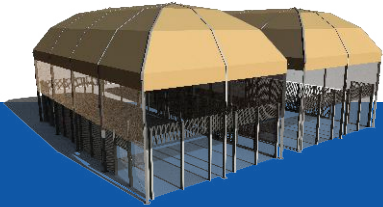
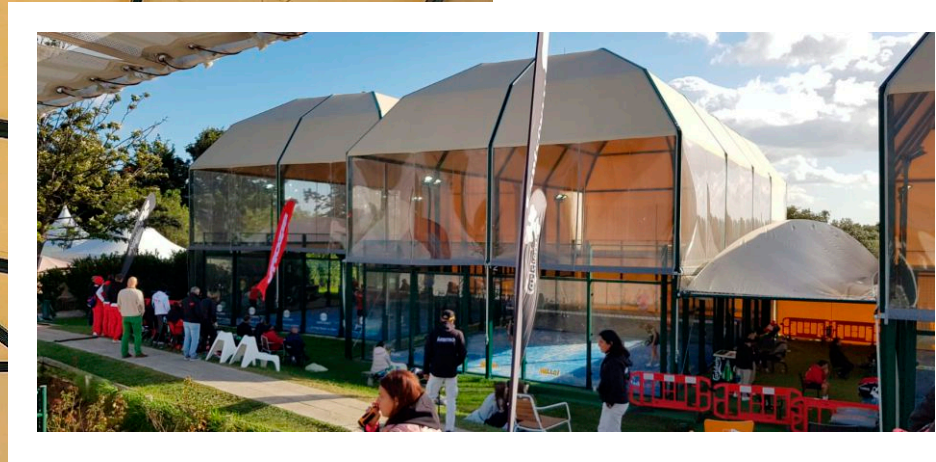
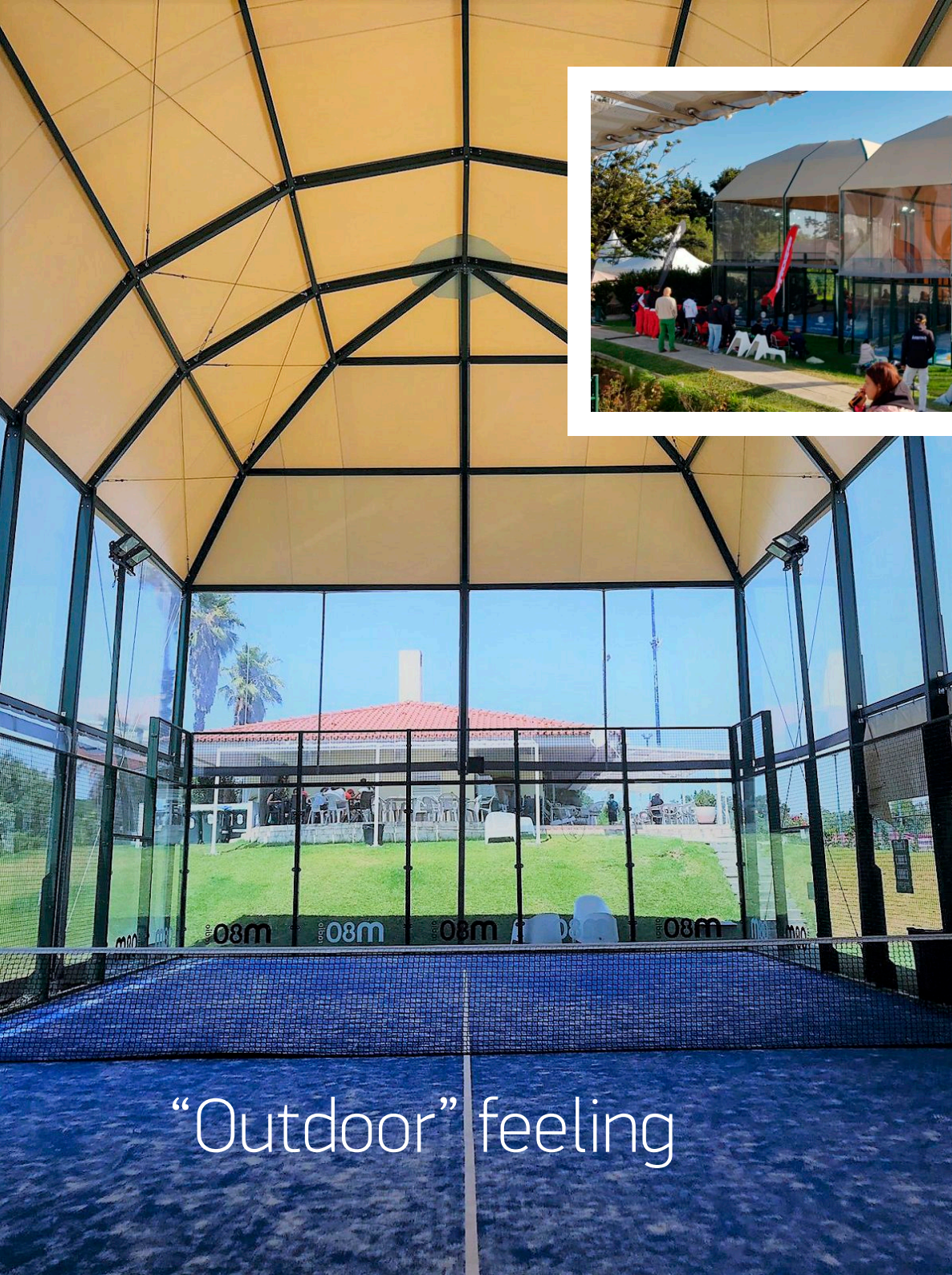

A structure to cover individual or multiple paddle courts, with an aesthetic and light design of easy installation, without damaging the paddle or tennis court.

You can play without worrying about weather inclemency. In addition, the optional integrated illuminating system allows the lighting up of the courts when it is cloudy or dark.

Different sidewalls closures options. Canvas, sheet or micro drilled tissue, to avoid the wind interrupting the match.

Avoids the excessive heating of the paddle court.

Membrane is flame retardant, anti-bacteria and UV treated and is very weather resistant.

Possible to supply it in different colours.

“Outdoor” feeling

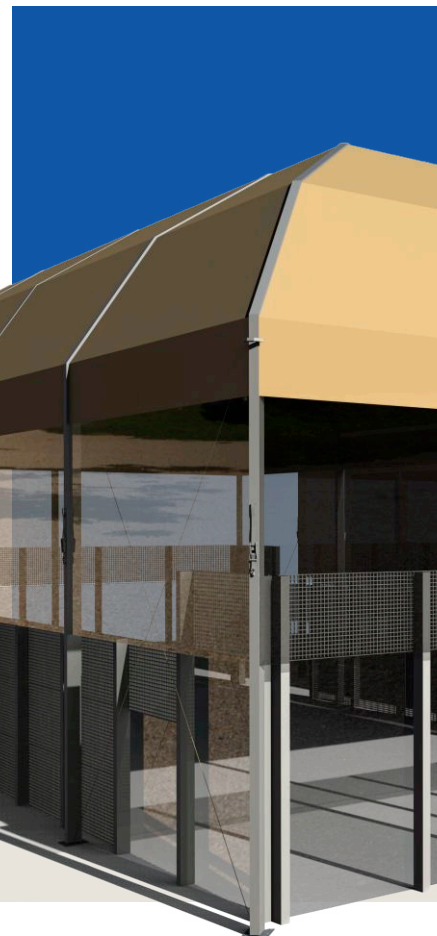
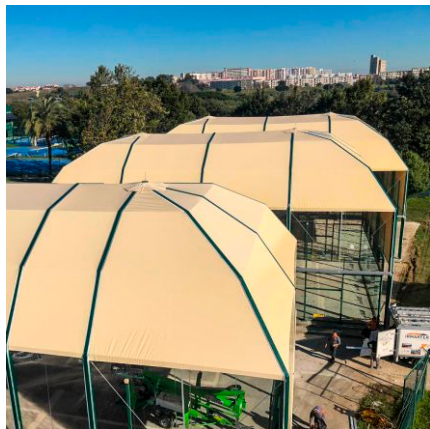
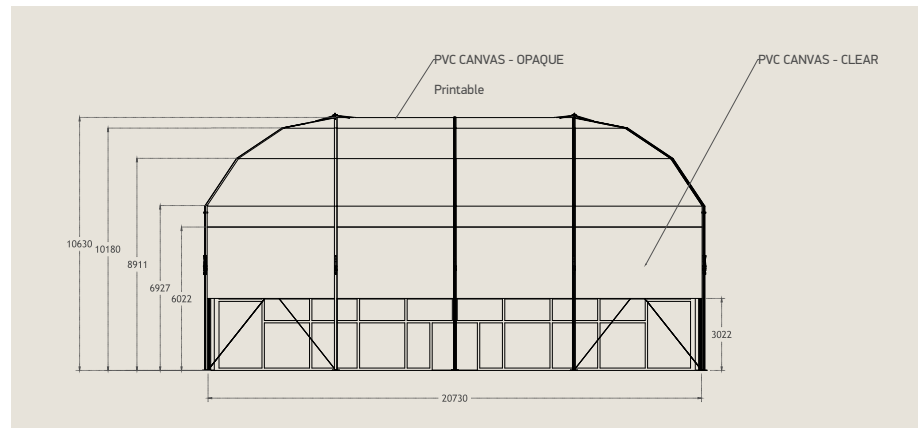
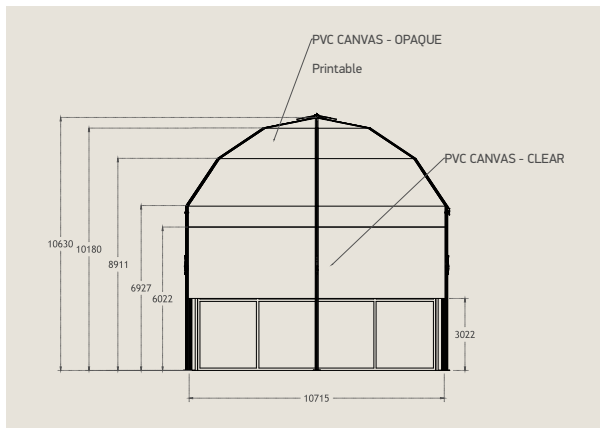

01

Non required maintenance and high durability.

02

Avoids the blinding direct sun in the central hours of the day.

03

It allows playing on rainy days.

04

The condensation does not take place in the glass walls during the night.

05

Prevents the Court moistening from the morning dew.

06

Split Court corridor covers available.

07

Different colour combos.

08

Rigid, stable and durable materials. 5 year guaranteed.

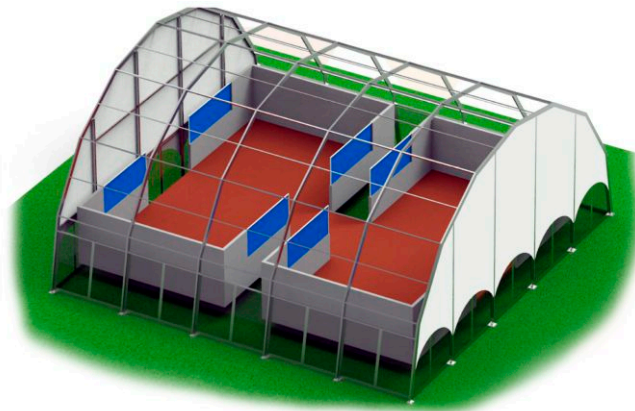
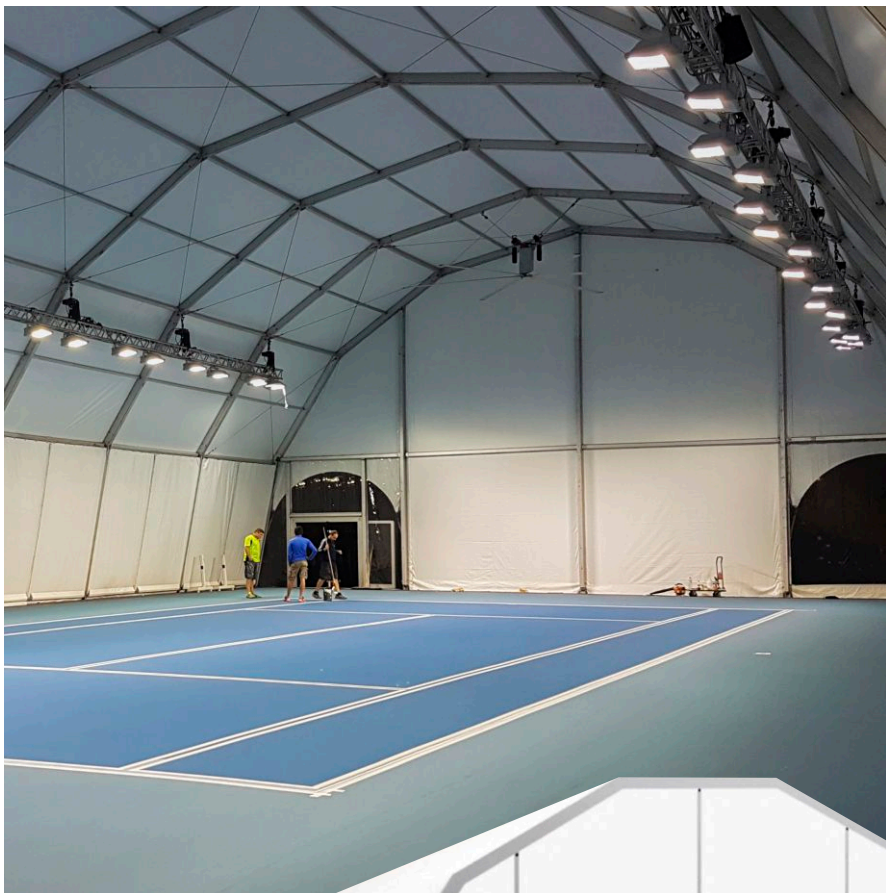

09

Different coverage models for Padel and Tennis.

10

Flexible dimensions.

11

Customization feasibility.

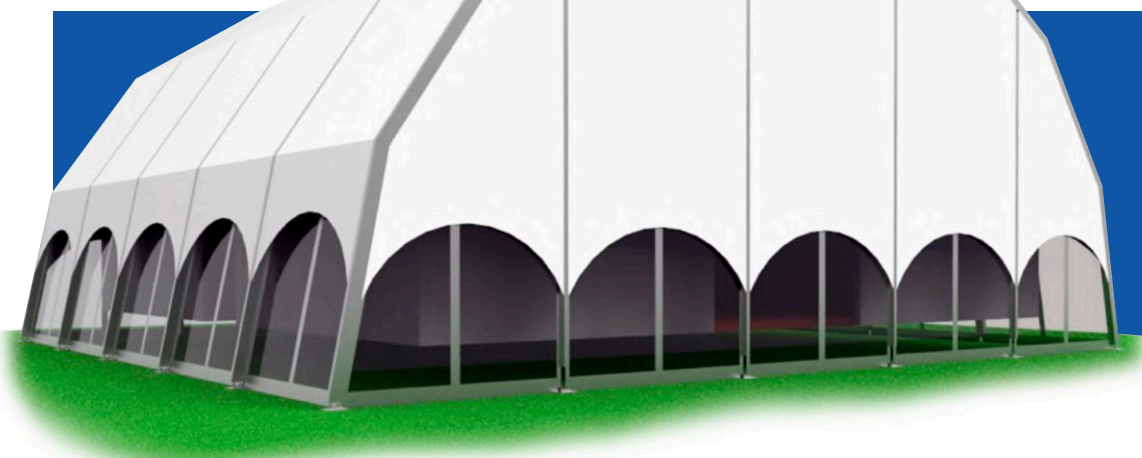
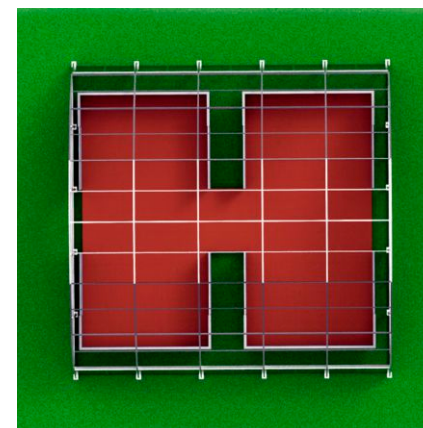

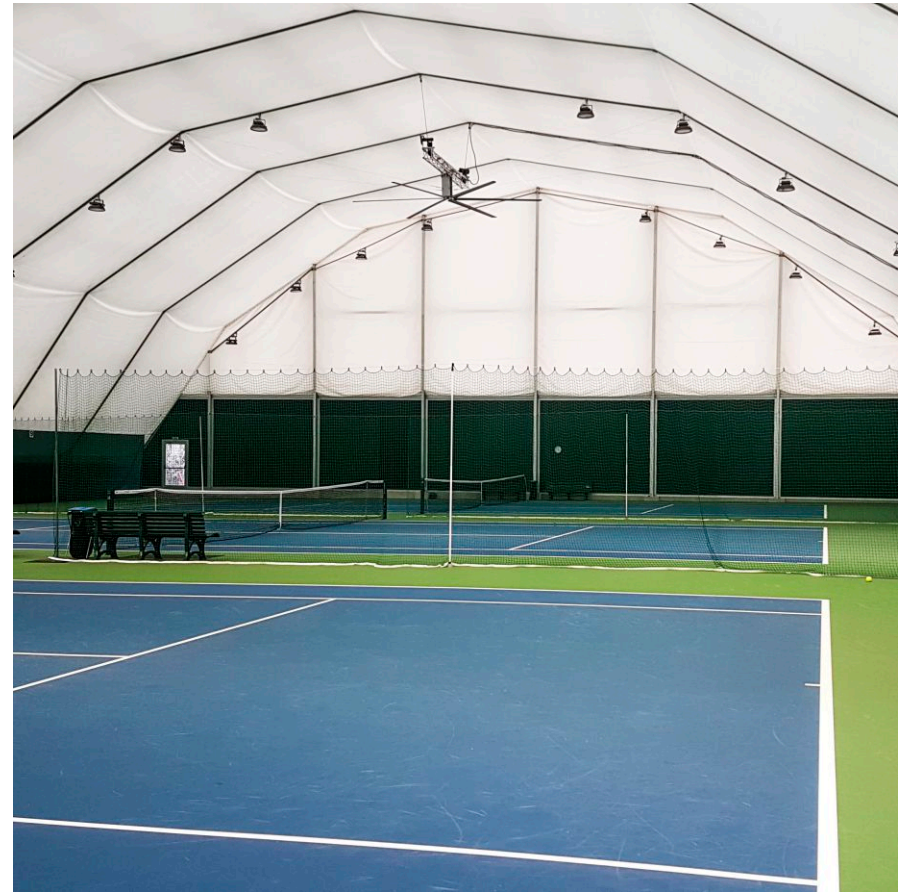
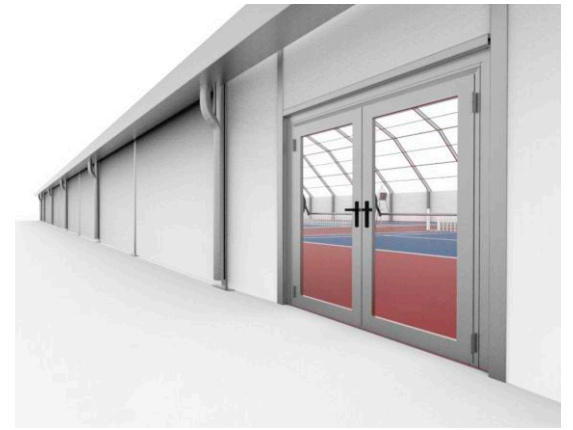

SAFE . FUNCTIONAL . DESIGN

READY FOR THE FUTURE

WWW.IRMARFER.CH
office@irmarfer.ch

**IRMARFER**
STRUCTURES **CH**